

TECHNICAL SPECIFICATIONS

TBK195



Breaker code	Rev.	Year
TBK01950	1	2025

Versione standard
Standard version

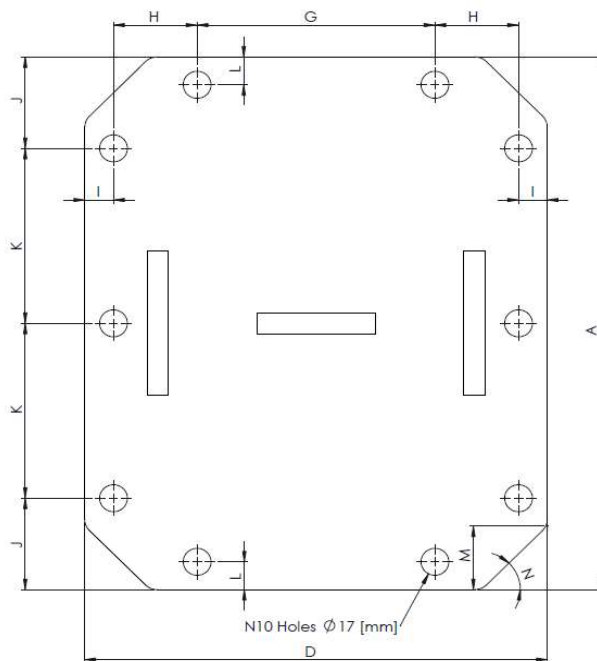
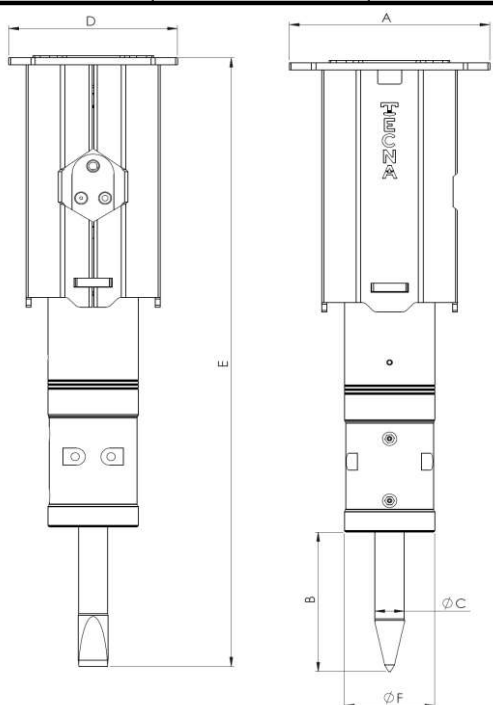

	mm	in		mm	in
A	335	13,2	H	51	2,0
B	246	9,7	I	17,5	0,7
φ C	49	1,9	J	57,5	2,3
D	282	11,1	K	110	4,3
E	1070	42,1	L	17,5	0,7
F	141	5,6	M	40	1,6
G	145	5,7	N	45°	45°

I	GB	D	METRIC UNIT / IMPERIAL UNIT			
PESO ESCAVATORE	SUITABLE EXCAVATOR	GEWICHTSKLASSE	2,5 ÷ 4,5	Ton	5512 ÷ 9921	lbs
PESO MEDIO OPERATIVO	OPERATING WEIGHT	EINSATZGEWICHT DES HAMMERS	180	Kg	396,8	lbs
DIAMETRO UTENSILE	TOOL DIAMETER	MEIBEL-DURCHMESSER (MM)	49	mm	1,93	in
PORTATA	OIL SUPPLY	ÖLMENGE MIN/MAX (L/MIN)	35 ÷ 55	l/min	9 ÷ 15	GPM
PRESSIONE DI LAVORO	BREAKER WORKING PRESSURE	BETRIEBSDRUCK DES HAMMERS	100 ÷ 150	bar	1450 ÷ 2176	PSI
PRESSIONE REGOLATA ALL'ESCAVATORE	RELIEF PRESSURE SETTING	EINGESTELLTER ARBEITSDRUCK AM BAGGER	180	bar	2611	PSI
CONTROPRESSIONE MAX	MAX BACK PRESSURE	MAX. ZULÄSSIGER RÜCKLAUFSTAUDRUCK	25	bar	363	PSI
POTENZA INGRESSO (MAX)	INPUT POWER (MAX)	MAX. HYDRAULISCHE EINGANGSLEISTUNG	11	Kw	15,4	HP
CLASSE DI ENERGIA D'URTO	IMPACT ENERGY CLASS	EINZELSCHLAGENERGIE	760	J	561	Ft/lbs
NUMERO DI COLPI AL MINUTO	IMPACT RATE	SCHLAGFREQUENZ PRO MINUTE	600 ÷ 930	BPM	600 ÷ 930	BPM
TEMPERATURA MAX OLIO IDRAULICO	MAX TEMPERATURE HYDRAULIC OIL	MAX. ÖLTEMPERATUR	80	°C	176	°F
TUBAZIONE IMPIANTO MANDATA (Ø min.)	RECOMMENDED INLET LINE SIZE (Ø min.)	EINLASSSCHLAUCH (Ø MIN.)	12	mm	0,47	in
TUBAZIONE IMPIANTO RITORNO (Ø min.)	RECOMMENDED RETURN LINE SIZE (Ø min.)	AUSLASSSCHLAUCH (Ø MIN.)	14	mm	0,55	in
LUNGHEZZA CONSIGLIATA TUBI FLESSIBILI	SUGGESTED MIN FLEX HOSES LENGTH	EMPFOHLENE SCHLAUCHLÄNGE	1600	mm	63,0	in
ATTACCO INGRESSO DEMOLITORE	HOSE CONNECTION AT THE BREAKER'S RETURN LINE	SCHLAUCHKUPPLUNG - RÜCKLAUF	1/2" G		1/2" G	
ATTACCO USCITA DEMOLITORE	HOSE CONNECTION AT THE BREAKER'S INLET LINE	SCHLAUCHKUPPLUNG - VORLAUF	1/2" G		1/2" G	

Breaker code

Rev.

Year

Versione standard
Standard version

TBK01950

1

2025

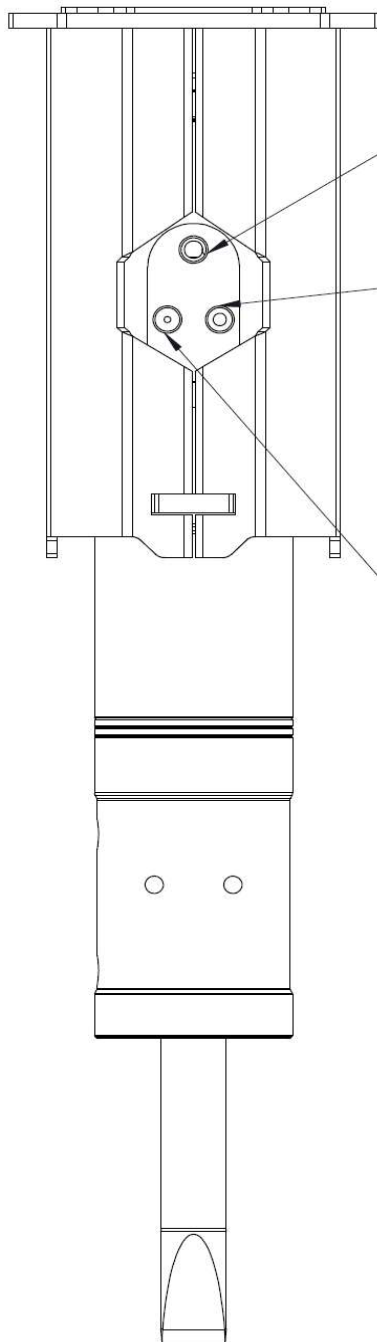

OIL INLET
INGRESSO OLIO
OEL EINGANGVERBINDUNG

STANDARD OIL OUTLET
 for all pressurized circuit
 (backflow pressure
 at excavator > 15 [bar])

USCITA OLIO STANDARD
 per circuiti pressurizzati
 (pressione di ritorno all'escavatore
 <15 [bar])

STANDARD OEL AUSLASSVERBINDUNG
 ist für die neueste Bagger Generation:
 Staudruck >15 [bar]

ALTERNATIVE OIL OUTLET
 to be used with not pressurized circuit
 (backflow pressure
 at excavator up to 15 [bar])

USCITA OLIO ALTERNATIVA
 da utilizzare con circuiti non pressurizzati
 (pressione di ritorno all'escavatore
 fino a 15 [bar])

ALTERNATIVE AUSLASSVERBINDUNG
 ist für die Baggersysteme ohne Hilfsstromkreis
 mit Staudruck <=15 [bar]

The hammer is shipped with the standard oil outlet ready for the plug-in. Use the standard outlet if the excavator backflow pressure or circuit type is unknown.

Il martello è consegnato con l'uscita standard pronta per essere connessa. Utilizzare questa uscita olio se non si conosce la pressione del circuito di ritorno olio o il tipo di circuito dell'escavatore.

Der Hammer wird immer mit der Standard Auslassverbindung fertig für den Einsatz ausgeliefert. Sollten Sie den Rückstaudruck oder das Hydrauliksystem des Baggers nicht kennen, benutzen Sie diese Schlauchkupplung.

Breaker code

Rev.

Year

Versione standard
Standard version

TBK01950

1

2025

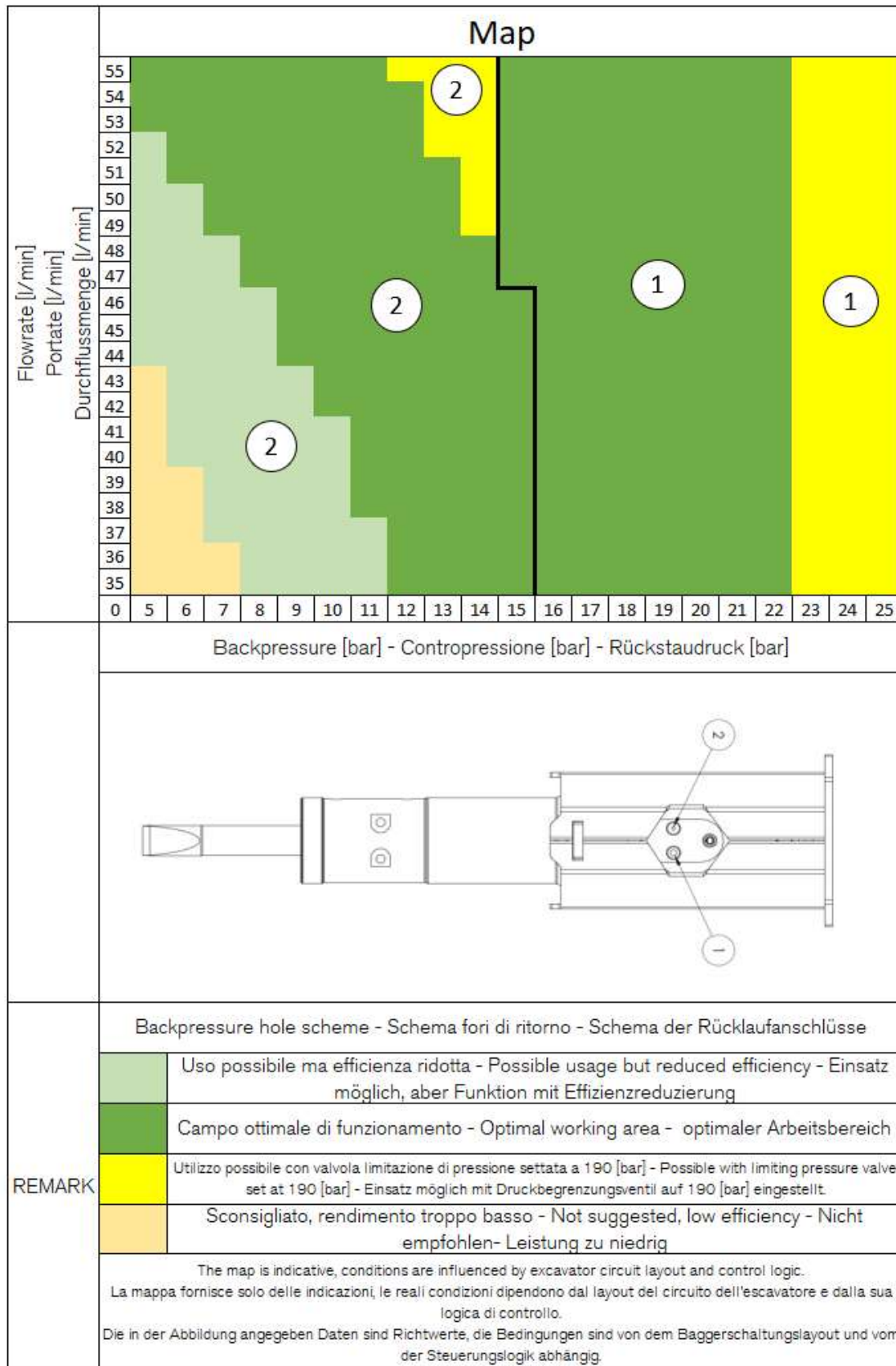

PARTS LIST				TBK195	
Breaker code	Rev.	Year	Versione standard Standard version		
TBK01950		1	2025		
POS.	I	GB	D	CODE	N° of PARTS
001	TESTATA	HEAD	KOPFTEIL	TBK01800010	1
002	SCATOLA DISTRIBUZIONE	DISTRIBUTOR BOX	SCHIEBERGEHÄUSE	TBK01800020	1
003	O RING	O RING	O-RING	06350 *	2
004	DISTRIBUTORE	DISTRIBUTOR	STEUERSCHIEBER	TBK01800040	1
005	O RING	O RING	O RING	06320 *	1
007	VITE ANCORAGGIO	FIXING SCREW	VERSCHLUSSSCHRAUBE	TBK01800070	4
101	CILINDRO	CYLINDER	ZYLINDER	TBK01801010	1
102	O RING	O RING	O RING	06320 *	4
104	GUARNIZIONE A LABBRO	LIP SEAL	LIPPENDICHTUNG	04190 *	1
105	PARAPOLVERE	DUST SEAL	STAUBRING	19180 *	1
109	PISTONE	PISTON	SCHLAGKOLBEN	TBK1801090	1
111	SPINA CORPO	HOUSING PIN	GEHAUSE STIFT	01030	3
201	CORPO CILINDRO	CYLINDER HOUSING	ZYLINDER GEHAUSE	TBK01802010	1
203	EXPANDER	EXPANDER	EXPANDER	15051	1
206	INGRASSATORE	GREASE NIPPLE	SCHMIERNIPPEL	12000	2
208	FERMAUTENSILE	RETAIN AXLE	SPERRACHSE	T02002080	2
210	Q-RING	Q-RING	Q-RING	07002 *	2
253	BOCCOLA	CHUCK BUSH	MEIßSELBUCHSE	TBK01802530	1
254	SEEGER	SEEGER	SEEGER	02050	1
255	O RING	O RING	O RING	05150 *	2
302	CAPSULA SUPERIORE	UPPER SHELL	OBERE FLANSCH	TBK01803020	1
303	MEMBRANA	DIAPHRAGM	MEMBRANE	T02003030**	1
304	VITE CARICA AZOTO	INFLATING SCREW	FÜLLSCHRAUBE	T03003040**	1
305	RONDELLA	WASHER	USIT RING	14020 **	1
306	VITE	SCREW	SCHRAUBE	07120	12
307	RONDELLA AUTOBLOCCANTE	SELF LOKING WASHER	UNTERLEGSCHIEBE	11000	12
500	CARCASSA	CASING	GEHÄUSE	TBK01805001	1
501	AMMORTIZZATORE SUPERIORE	SHOCK ABSORBER UPPER	OBERER STOßDÄMPFER	TBK01805010	1
503	AMMORTIZZATORE INFERIORE	SHOCK ABSORBER LOWER	UNTERER STOßDÄMPFER	TBK01805030	1
511	SELLA	CRADLE	SCHNELLWECHSLERAUFN AHME	TBK01805110	1
512	VITE	SCREW	SCHRAUBE	10270	10
513	DADO AUTOBLOCCANTE	SELF LOKING NUT	SICHERUNGSMUTTER	13130	10
600	UTENSILE A SCALPELLO	CHISEL	FLACHMEißEL - SENKRECHTER SCHNITT	TBK01806000	1

PARTS LIST

TBK195

Breaker code			Rev.	Year	Versione standard Standard version	
TBK01950			1	2025		
POS.	I	GB	D	CODE	N° of PARTS	
601	UTENSILE A CONO	MOIL POINT	SPITZMEIBEL (KONISCH ZULAUFEND)	TBK01806010	1	
602	UTENSILE PIATTO	BLUNT TOOL	STUMPFMEIBEL	TBK01806020	1	
603	UTENSILE TAGLIASFALTO	ASPHALT CUTTER	BREIT-FLACHMEIBEL (ASPHALTSCHNEIDER)	TBK01806030	1	
604	UTENSILE TAGLIALEGNA	WOOD CUTTER	SPRENGMEISSEL	TBK01806040	1	
605	UTENSILE VANGHETTA	SPADE TOOL	SPITZSPATMEISSEL	TBK01806050	1	
607	UTENSILE BATTIPALO	PILE DRIVER TOOL	RAMMGLOCKE	TBK01806070	1	
610	UTENSILE A DISEGNO	TOOL ON REQUEST	MEISSELAUSFÜHRUNGEN NACH KUNDENWUNSCH	TBK01806100	1	

*	KIT GUARNIZIONI	SEAL KIT	DICHTUNGSSÄTZE	KTBK01801	1
**	KIT MEMBRANA	DIAPHRAGM KIT	MEMBRANE KIT	KM02000	1
	KIT BATTIPALO	PILE DRIVER KIT	PFOSTENRAMME	KTBK01950	1
	KIT CARICA AZOTO	NITROGEN INFLATING KIT	STICKSTOFFSPEICHER KIT	KCN20010	1

PARTS LIST

TBK195

PARTS LIST				TBK195			
Breaker code		Rev.	Year	Versione standard Standard version			
TBK01950		1	2025				
POS.	I	GB	D	TOOL FOR SCREW ASSEMBLY	Nm	in*lbf	
007	VITE DI CHIUSURA	CLOSING SCREW	VERSCHLUSSSCHRAUBE N	24	395	3496	
304	VITE CARICA AZOTO	INFLATING SCREW	FÜLLSCHRAUBE	B 8	80	708	
306	VITE CHIUSURA CAPSULA	SELL FIXING SCREW	AKKUSCHRAUBEN	B 8	80	708	
401	NIPPLO INGRESSO/USCITA	1/2" PLUG	1/2 ZOLL DOPPELNIPPEL	27	200	1770	
512	VITE ATTACCO SELLA	CRADLE SCREW	BEFESTIGUNGSSCHRAU BE DER AUFNAHME	19	100	885	
	PRESSIONE CARICA AZOTO	NITROGEN CHARGIN PRESSION	FÜLLDRUCK DES STICKSTOFFES	40	bar	580 PSI	

Exploded View Hammer

TBK195



Breaker code

Rev.

Year

Versione standard
Standard version

TB01950

1

2025

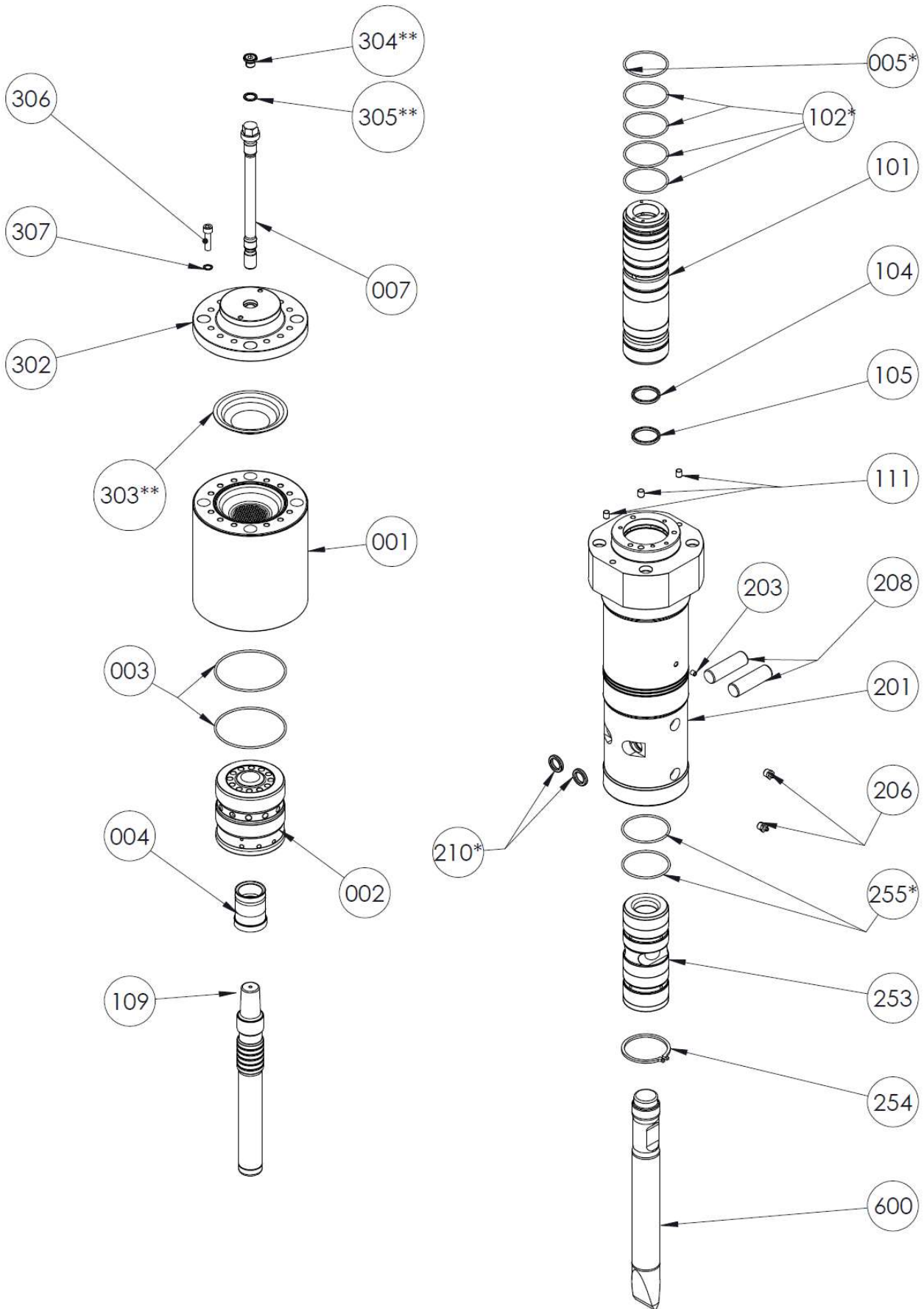

Breaker code

Rev.

Year

Versione standard
Standard version

TB01950

1

2025

